

## Ridge Ventilation Terminals

The Russell Ridge Ventilation Terminal is a means of ventilating the roof space at a high level or venting a soil vent pipe or mechanical extract. The cowl prevents snow or wind driven rain entering the unit. If a ridge board is fitted it should be cut back for the length of 400mm and trimmed. The underlay is cut to fit the PVC-u insert. When fitted, ensure it is at least 600mm away from any gas vent terminals or outlets. It can be used with an adaptor and flexible pipe (supplied separately) to terminate a soil and vent pipe.

- Manufactured in Universal Angle, Half Round and Multi Ridge tile profiles.
- Each unit provides 8770mm<sup>2</sup> free ventilation area.
- To meet the requirement of 5000mm<sup>2</sup> (equivalent of a continuous 5mm gap) free ventilation area per metre run of ridge the unit should be spaced at max. 1.75m c/c
- Not suitable for hot exhaust gases

**Air Vent  
Ridge Terminal**

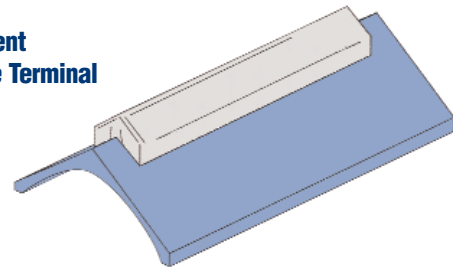

**PVC-u Underlay  
insert**

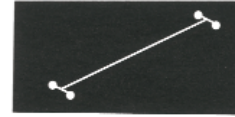

**Adaptor**



**Flexipipe**



# Typical Details

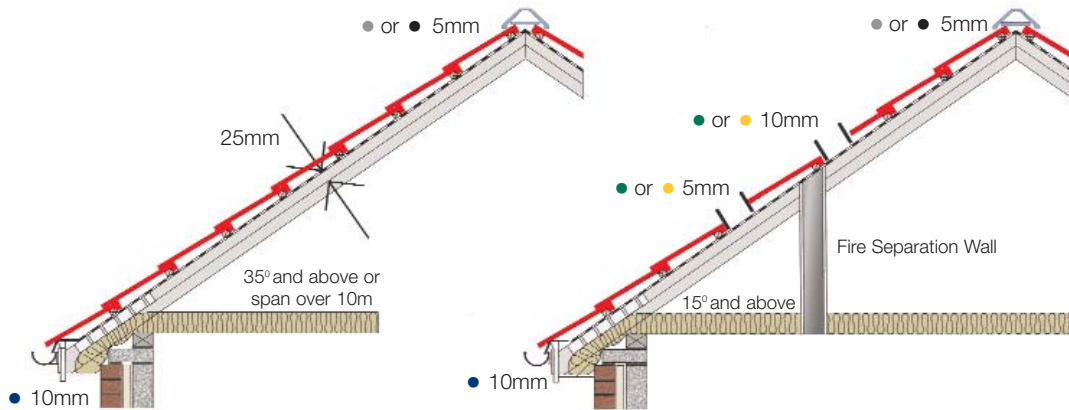

**Cold roof construction duo pitch**

**Cold roof construction**

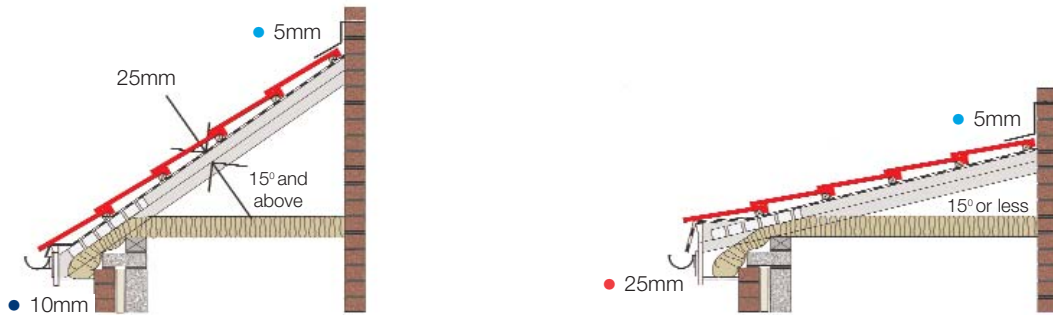

**Cold roof abutment construction**

**Cold roof abutment construction**

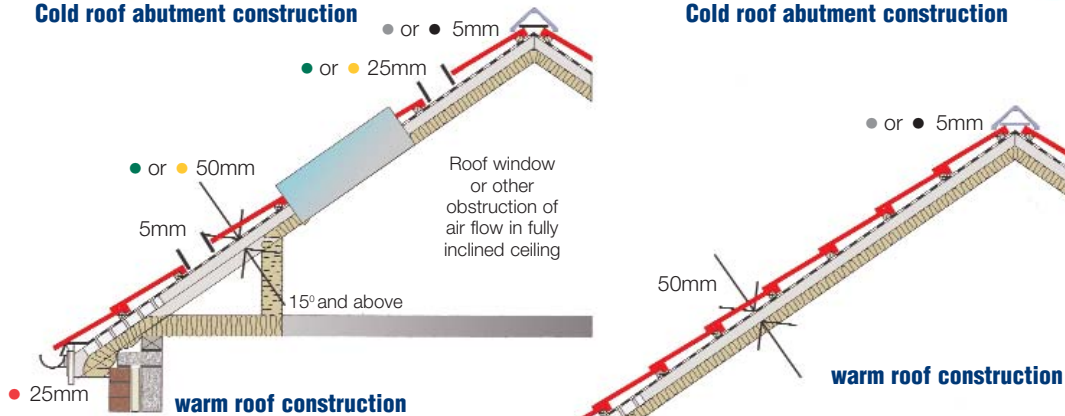

**warm roof construction**

**warm roof construction**

Suggested products to meet roof space ventilation are:

- Russell Eaves Ventilation System 10mm
- Russell Eaves Ventilation System 25mm
- Russell Dry Ventilated Ridge System
- Russell Concrete Tile Ventilation Terminals
- Russvent PVC-u Tile Ventilation Terminals
- Russell Abutment Ventilation System
- Russell Ridge Ventilation Terminals

Dimensions stated in mm relate to the opening per metre run of eaves, ridge, abutment etc. A continuous opening of 10mm corresponds to ventilation area equivalent to 10,000mm<sup>2</sup> per metre. The above roof sections provide typical guidance on requirements and interpret the Building Regulations and recommendations given in BS 5250. For further advice and technical information, please contact the Technical Department.

## CEMEX Roof Tiles

Nicolson Way, Wellington Road, Burton-on-Trent, Staffordshire, DE14 2AW  
Tel: 01283 517070 Fax: 01283 516290

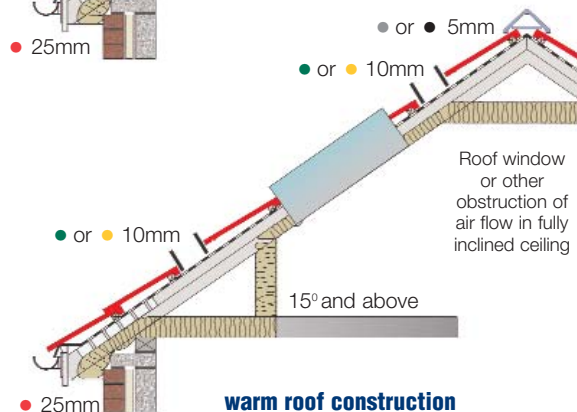

**warm roof construction**