

Cloaked Verge System

The Russell Cloaked Verge System is designed to provide a mechanical dry, durable mortarless finish to the verge.

- Eliminates the need for mortar bedding and pointing.
- Components comply with BS EN 490 & 491 : 1994, BS 5534 : and BS 8000 :
- Maintenance free.
- Fast installation in all weather conditions.
- Attractive, neat uniform finish to the verge.
- Purpose made half tiles provide flexibility to allow setting out.
- Block End Ridges (either Universal Angle or Half Round) provide a neat weatherproof finish at the apex.
- Are available in colours and finishes to match Derwent, Double Roman and Pennine profiles to assist in setting out.
- Cloak Verge tiles are compatible for use with Russell Dry Fix Ridge Systems.



Dimensions

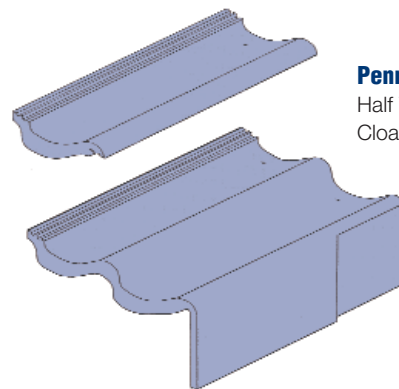
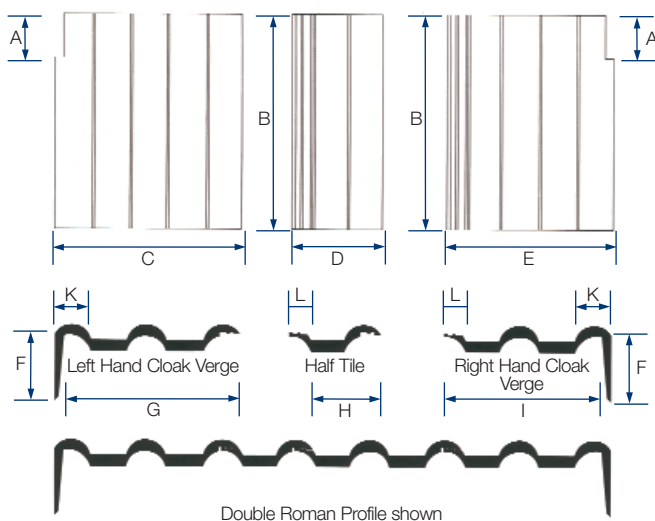

Pennine

Half Tile and Right Hand Cloak Verge Unit

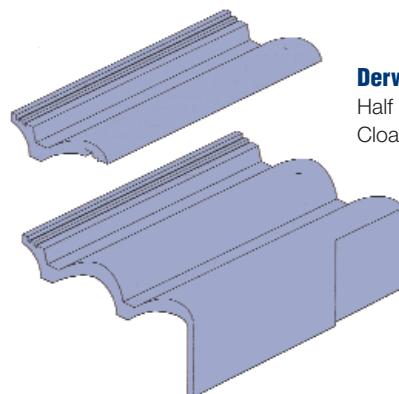

Derwent

Half Tile and Right Hand Cloak Verge Unit

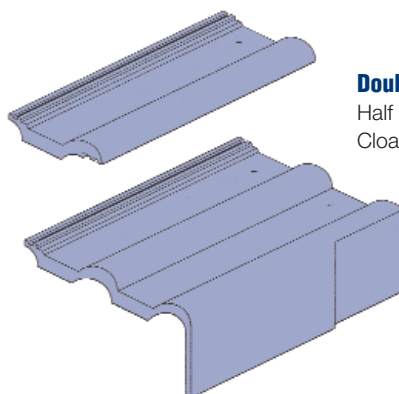

Double Roman

Half Tile and Right Hand Cloak Verge Unit

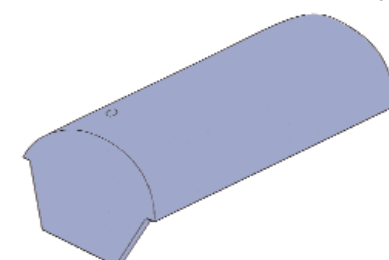

Half Round

Block End Ridge

